

公制螺纹卡套接头

Metric Thread bite Type Tube Fitting

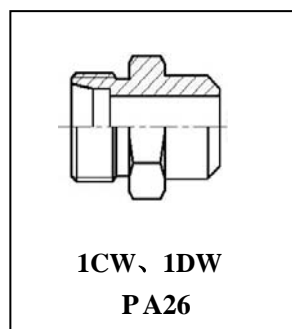

公制螺纹卡套接头

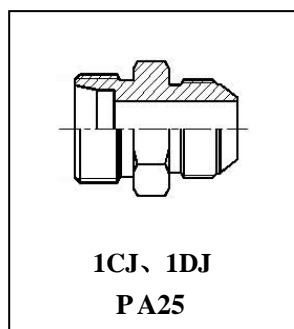
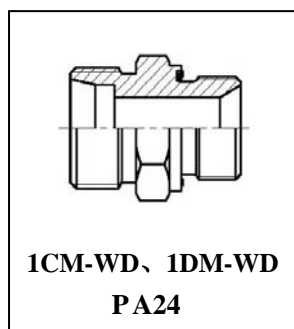
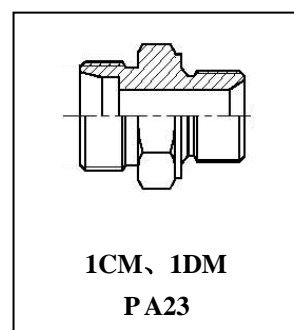
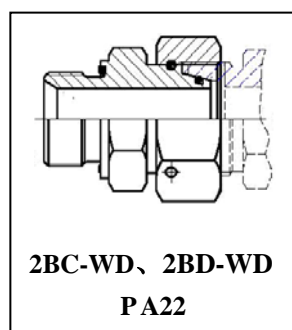
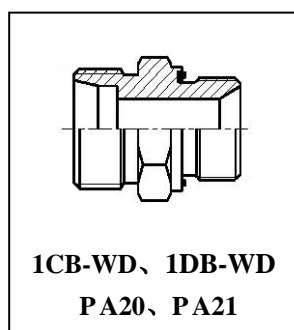
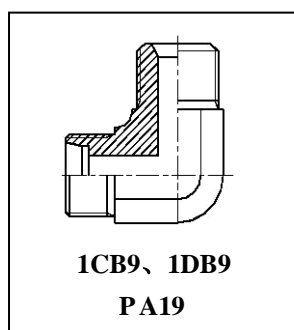
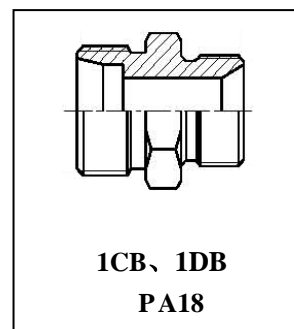
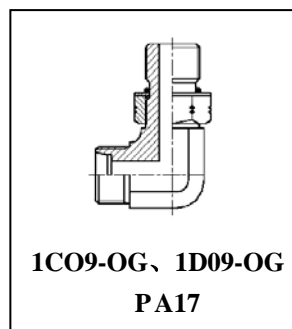
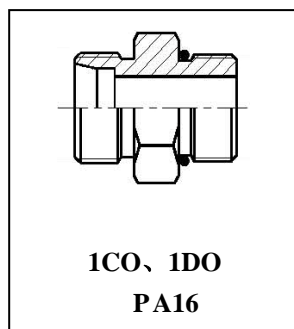
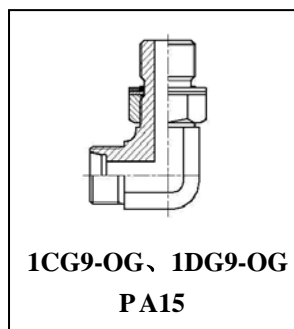
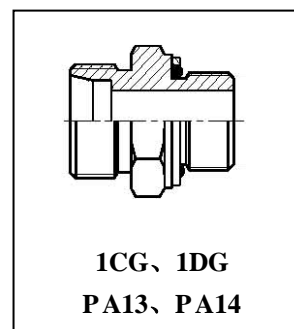
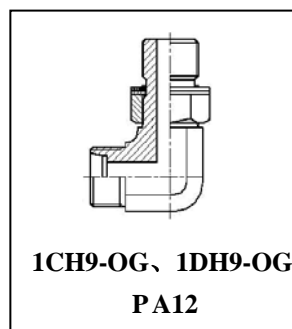
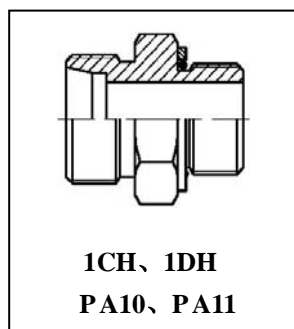
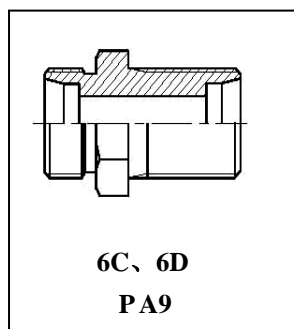
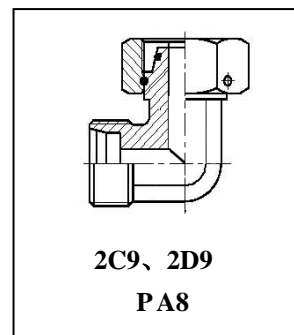
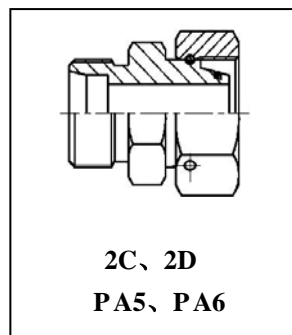
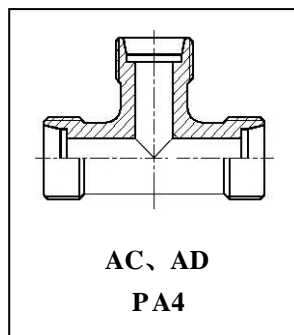
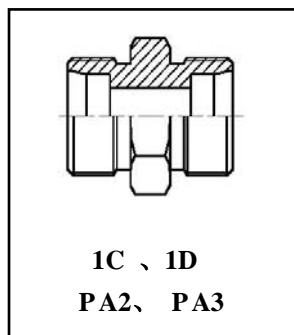
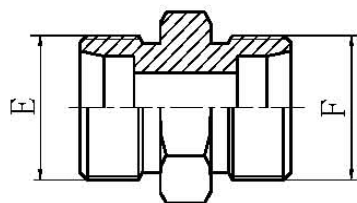

1C

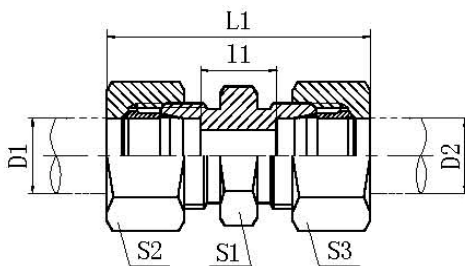

1C-RN

直通接头

STRAIGHT FITTINGS

代号 PART NO.	螺 纹 THREAD		管子外径 TUBE O.D.		尺 寸 DIMENSIONS						压力等级 Mpa
	E	F	D1	D2	l1	L1	S1	S2	S3		
1C-12	M12X1.5	M12X1.5	6	6	10	39	12	14	14		31.5 轻系列 L
1C-12-14	M12X1.5	M14X1.5	6	8	11	40	14	15	17		
1C-12-16	M12X1.5	M16X1.5	6	10	12	41	17	15	19		
1C-12-18	M12X1.5	M18X1.5	6	12	13	42	19	15	22		
1C-14	M14X1.5	M14X1.5	8	8	11	40	14	17	17		
1C-14-16	M14X1.5	M16X1.5	8	10	13	41	17	17	19		
1C-14-18	M14X1.5	M18X1.5	8	12	13	42	19	17	22		
1C-16	M16X1.5	M16X1.5	10	10	13	42	17	19	19		
1C-16-18	M16X1.5	M18X1.5	10	12	14	43	19	19	22		
1C-16-22	M16X1.5	M22X1.5	10	15	15	44.5	24	19	27		
1C-16-26	M16X1.5	M26X1.5	10	18	15.5	46	27	19	32		
1C-18	M18X1.5	M18X1.5	12	12	14	43	19	22	22		
1C-18-22	M18X1.5	M22X1.5	12	15	15	44.5	24	22	27		
1C-18-26	M18X1.5	M26X1.5	12	18	15.5	46	27	22	32		
1C-18-30	M18X1.5	M30X2	12	22	17.5	48	32	22	36		
1C-22	M22X1.5	M22X1.5	15	15	16	46	24	27	27		
1C-22-26	M22X1.5	M26X1.5	15	18	16.5	47.5	27	27	32		
1C-22-30	M22X1.5	M30X2	15	22	18.5	49.5	32	27	36		
1C-26	M26X1.5	M26X1.5	18	18	16	48	27	32	32		
1C-26-30	M26X1.5	M30X2	18	22	18	50	32	32	36		
1C-26-36	M26X1.5	M36X2	18	28	19	51.5	41	32	41		
1C-30	M30X2	M30X2	22	22	20	52	32	36	36		
1C-30-36	M30X2	M36X2	22	28	21	53.5	41	36	41		
1C-30-45	M30X2	M45X2	22	35	21	58.5	46	36	50		
1C-36	M36X2	M36X2	28	28	21	54	41	41	41		
1C-36-45	M36X2	M45X2	28	35	21	59	46	41	50		
1C-45	M45X2	M45X2	35	35	20	63	46	50	50		
1C-52	M52X2	M52X2	42	42	21	66	55	60	60		

注: 如需带卡套及卡套螺母整套订货, 则请在代号后加“RN”, 如1C-30RN。

Note: In case if you are interested to order the adapter in complete set with cutting ring and nut , it is necessary to insert suffix "RN" after our part no., for example 1C-30RN.

可按用户要求生产各种标准, 型号, 材质的产品

公制螺纹卡套接头

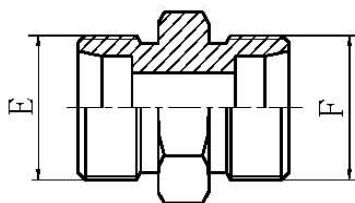

1D

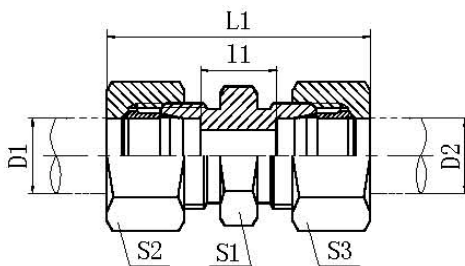

1D-RN

直通接头

STRAIGHT FITTINGS

代号 PART NO.	螺 纹 THREAD		管子外径 TUBE O.D.		尺 寸 DIMENSIONS						压力等级 Mpa
	E	F	D1	D2	l1	L1	S1	S2	S3		
1D-14	M14X1.5	M14X1.5	6	6	16	45	14	17	17		63 重系列 S
1D-14-16	M14X1.5	M16X1.5	6	8	18	47	17	17	19		
1D-14-18	M14X1.5	M18X1.5	6	10	17.5	48	19	17	22		
1D-14-20	M14X1.5	M20X1.5	6	12	19.5	50	22	17	24		
1D-16	M16X1.5	M16X1.5	8	8	18	47	17	19	19		
1D-16-18	M16X1.5	M18X1.5	8	10	17.5	48	19	19	22		
1D-16-20	M16X1.5	M20X1.5	8	12	19.5	50	22	19	24		
1D-18	M18X1.5	M18X1.5	10	10	17	49	19	22	22		
1D-18-20	M18X1.5	M20X1.5	10	12	19	51	22	22	24		
1D-18-22	M18X1.5	M22X1.5	10	14	20.5	54	24	22	27		
1D-18-30	M18X1.5	M30X2	10	20	22	59.5	32	22	36		
1D-20	M20X1.5	M20X1.5	12	12	19	51	22	24	24		
1D-20-22	M20X1.5	M22X1.5	12	14	20.5	54	24	24	27		
1D-20-24	M20X1.5	M24X1.5	12	16	20	54	27	24	30		
1D-20-30	M20X1.5	M30X2	12	20	22	59.5	32	24	36		
1D-22	M22X1.5	M22X1.5	14	14	22	57	24	27	27		
1D-22-24	M22X1.5	M24X1.5	14	16	21.5	57	27	27	27		
1D-24	M24X1.5	M24X1.5	16	16	21	57	27	30	30		
1D-24-30	M24X1.5	M30X2	16	20	23	62.5	32	30	36		
1D-24-36	M24X1.5	M36X2	16	25	25.5	67.5	41	30	46		
1D-30	M30X2	M30X2	20	20	23	66	32	36	36		
1D-30-36	M30X2	M36X2	20	25	25.5	71	41	36	46		
1D-30-42	M30X2	M42X2	20	30	26	74	46	36	50		
1D-36	M36X2	M36X2	25	25	26	74	41	46	46		
1D-36-42	M36X2	M42X2	25	30	26.5	77	46	46	50		
1D-42	M42X2	M42X2	30	30	27	80	46	50	50		
1D-42-52	M42X2	M52X2	30	38	28.5	86.5	55	50	60		
1D-52	M52X2	M52X2	38	38	29	90	55	60	60	31.5重系列S	

注: 如需带卡套及卡套螺母整套订货, 则请在代号后加“RN”, 如1C-30RN。

Note: In case if you are interested to order the adapter in complete set with cutting ring and nut , it is necessary to insert suffix "RN" after our part no., for example 1C-30RN.

可按用户要求生产各种标准, 型号, 材质的产品

公制螺纹卡套接头

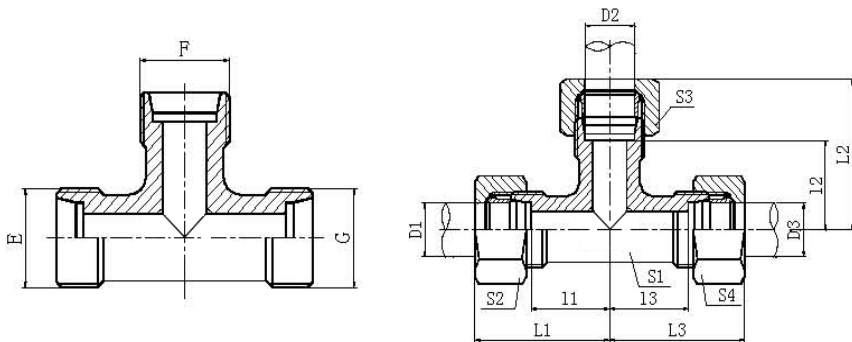

AC
AD

AC-RN
AD-RN

三通接头
EQUAL TEES

代号 PART NO.	螺纹 THREAD	管子外径 TUBE O.D.	尺寸 DIMENSIONS					压力等级 Mpa
	E, F, G	D1, D2, D3	11, 12, 13	L1, L2, L3	S1	S2, S3, S4		
AC-08	M8X1	4	11	21	9	10	10 特轻系列 LL	
AC-10	M10X1	5	9.5	21	9	12		
AC-10A	M10X1	6	9.5	21	9	12		
AC-12A	M12X1	8	11.5	23	12	14		
AC-12	M12X1.5	6	12	27	12	14	25 轻系列 L	
AC-14	M14X1.5	8	14	29	12	17		
AC-16	M16X1.5	10	15	30	14	19		
AC-18	M18X1.5	12	17	32	17	22		
AC-22	M22X1.5	15	21	36	19	27		
AC-26	M26X1.5	18	23.5	40	24	32		
AC-30	M30X2	22	27.5	44	27	36	16 轻系列 L	
AC-36	M36X2	28	30.5	47	36	41		
AC-45	M45X2	35	34.5	56	41	50		
AC-52	M52X2	42	40	63	50	60		
AD-14	M14X1.5	6	16	31	12	17	63 重系列 S	
AD-16	M16X1.5	8	17	32	14	19		
AD-18	M18X1.5	10	17.5	34	17	22		
AD-20	M20X1.5	12	21.5	38	17	24		
AD-22	M22X1.5	14	22	40	19	27		
AD-24	M24X1.5	16	24.5	43	24	30	40 重系列 S	
AD-30	M30X2	20	26.5	48	27	36		
AD-36	M36X2	25	30	54	36	46		
AD-42	M42X2	30	35.5	62	41	50		
AD-52	M52X2	38	41	72	50	60	31.5重系列S	

注: 如需带卡套及卡套螺母整套订货, 则请在代号后加“RN”, 如AC-22RN。

Note: In case if you are interested to order the adapter in complete set with cutting ring and nut, it is necessary to insert suffix "RN" after our part no., for example AC-22RN.

可按用户要求生产各种标准, 型号, 材质的产品

公制螺纹卡套接头

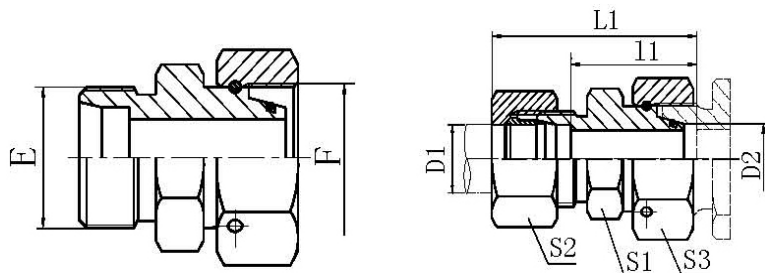

2C

2C-RN

外螺纹内螺纹转换接头
REDUCER TUBE ADAPTOR
WITH SWIVEL NUT

代号 PART NO.	螺 纹 THREAD		管子外径 TUBE O.D.		尺 寸 DIMENSIONS					压力等级 Mpa
	E	F	D1	D2	l1	L1	S1	S2	S3	
2C-12-14	M12X1.5	M14X1.5	6	8	23.5	38	12	14	17	31.5 轻系列 L
2C-12-16	M12X1.5	M16X1.5	6	10	25	40	14	14	19	
2C-14-16	M14X1.5	M16X1.5	8	10	25	40	14	17	19	
2C-12-18	M12X1.5	M18X1.5	6	12	25	40	17	14	22	
2C-14-18	M14X1.5	M18X1.5	8	12	25	40	17	17	22	
2C-16-18	M16X1.5	M18X1.5	10	12	26	41	17	19	22	
2C-12-22	M12X1.5	M22X1.5	6	15	28.5	43	19	14	27	
2C-14-22	M14X1.5	M22X1.5	8	15	28.5	43	19	17	27	
2C-16-22	M16X1.5	M22X1.5	10	15	29.5	44	19	19	27	
2C-18-22	M18X1.5	M22X1.5	12	15	29.5	44	19	22	27	
2C-12-26	M12X1.5	M26X1.5	6	18	28	43	24	14	32	
2C-16-26	M16X1.5	M26X1.5	10	18	29	44	24	19	32	
2C-18-26	M18X1.5	M26X1.5	12	18	29	44	24	22	32	
2C-22-26	M22X1.5	M26X1.5	15	18	30	45	24	27	32	
2C-12-30	M12X1.5	M30X2	6	22	32	47	27	14	36	16 轻系列 L
2C-14-30	M14X1.5	M30X2	8	22	32	47	27	17	36	
2C-16-30	M16X1.5	M30X2	10	22	33	48	27	19	36	
2C-18-30	M18X1.5	M30X2	12	22	33	48	27	22	36	
2C-22-30	M22X1.5	M30X2	15	22	34	49	27	27	36	
2C-26-30	M26X1.5	M30X2	18	22	33.5	50	27	32	36	
2C-12-36	M12X1.5	M36X2	6	28	34	49	36	14	41	
2C-14-36	M14X1.5	M36X2	8	28	34	49	36	17	41	
2C-16-36	M16X1.5	M36X2	10	28	35	50	36	19	41	
2C-18-36	M18X1.5	M36X2	12	28	35	50	36	22	41	
2C-22-36	M22X1.5	M36X2	15	28	36	51	36	27	41	
2C-26-36	M26X1.5	M36X2	18	28	35.5	52	36	32	41	
2C-30-36	M30X2	M36X2	22	28	37.5	54	36	36	41	
2C-12-45	M12X1.5	M45X2	6	35	37	52	41	14	50	
2C-14-45	M14X1.5	M45X2	8	35	37	52	41	17	50	
2C-16-45	M16X1.5	M45X2	10	35	38	53	41	19	50	
2C-18-45	M18X1.5	M45X2	12	35	38	53	41	22	50	

接下页

可按用户要求生产各种标准, 型号, 材质的产品

公制螺纹卡套接头

接上页

代号 PART NO.	螺 纹 THREAD		管子外径 TUBE O.D.		尺 寸 DIMENSIONS					压力等级 Mpa
	E	F	D1	D2	l1	L1	S1	S2	S3	
2C-22-45	M22X1.5	M45X2	15	35	39	54	41	27	50	16 轻系列 L
2C-26-45	M26X1.5	M45X2	18	35	38.5	55	41	32	50	
2C-30-45	M30X2	M45X2	22	35	40.5	57	41	36	50	
2C-36-45	M36X2	M45X2	28	35	40.5	57	41	41	50	
2C-12-52	M12X1.5	M52X2	6	42	40.5	55	50	14	60	
2C-14-52	M14X1.5	M52X2	8	42	40.5	55	50	17	60	
2C-16-52	M16X1.5	M52X2	10	42	41.5	56	50	19	60	
2C-18-52	M18X1.5	M52X2	12	42	41.5	56	50	22	60	
2C-22-52	M22X1.5	M52X2	15	42	42.5	58	50	27	60	
2C-26-52	M26X1.5	M52X2	18	42	42	58	50	32	60	
2C-30-52	M30X2	M52X2	22	42	44	60	50	36	60	
2C-36-52	M36X2	M52X2	28	42	44	61	50	41	60	
2C-45-52	M45X2	M52X2	35	42	43	65	50	50	60	

注: 如需带卡套及卡套螺母整套订货, 则请在代号后加“RN”, 如2C-30-52RN。

Note: In case if you are interested to order the adapter in complete set with cutting ring and nut , it is necessary to insert suffix "RN" after our part no., for example 2C-30-52RN.

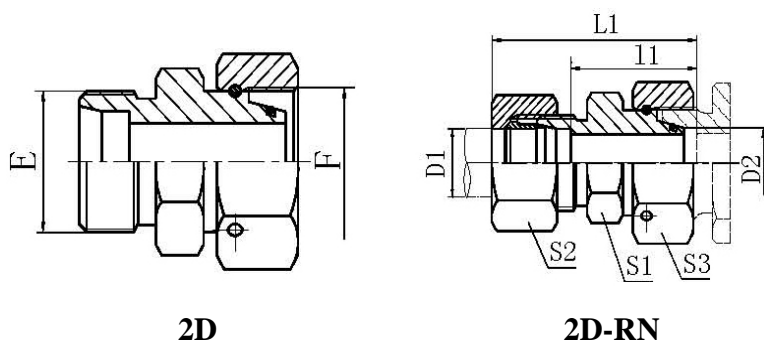

外螺纹内螺纹转换接头
REDUCER TUBE ADAPTOR
WITH SWIVEL NUT

代号 PART NO.	螺 纹 THREAD		管子外径 TUBE O.D.		尺 寸 DIMENSIONS					压力等级 Mpa
	E	F	D1	D2	l1	L1	S1	S2	S3	
2D-14-16	M14X1.5	M16X1.5	6	8	27	42	14	17	19	63 重系列 S
2D-14-18	M14X1.5	M18X1.5	6	10	27.5	42	17	17	22	
2D-14-20	M14X1.5	M20X1.5	6	12	29	44	17	17	24	
2D-14-22	M14X1.5	M22X1.5	6	14	31.5	46	19	17	27	
2D-16-18	M16X1.5	M18X1.5	8	10	27.5	42	17	19	22	
2D-16-20	M16X1.5	M20X1.5	8	12	29	44	17	19	24	
2D-16-22	M16X1.5	M22X1.5	8	14	31.5	46	19	19	27	
2D-18-20	M18X1.5	M20X1.5	10	12	31	46	19	22	24	
2D-18-22	M18X1.5	M22X1.5	10	14	31	47	19	22	27	
2D-20-22	M20X1.5	M22X1.5	12	14	31	47	22	24	27	

接下页

可按用户要求生产各种标准, 型号, 材质的产品



公制螺纹卡套接头

接上页

代号 PART NO.	螺 纹 THREAD		管子外径 TUBE O.D.		尺 寸 DIMENSIONS					压力等级 Mpa
	E	F	D1	D2	l1	L1	S1	S2	S3	
2D-14-24	M14X1.5	M24X1.5	6	16	32	47	22	17	30	40 重系列 S
2D-14-30	M14X1.5	M30X2	6	20	36	51	27	17	36	
2D-14-36	M14X1.5	M36X2	6	25	38.5	53	36	17	46	
2D-14-42	M14X1.5	M42X2	6	30	44	59	41	17	50	
2D-16-24	M16X1.5	M24X1.5	8	16	32	47	22	19	30	
2D-16-30	M16X1.5	M30X2	8	20	36	51	27	19	36	
2D-16-36	M16X1.5	M36X2	8	25	38.5	53	36	19	46	
2D-16-42	M16X1.5	M42X2	8	30	44	59	41	19	50	
2D-18-24	M18X1.5	M24X1.5	10	16	31.5	48	22	22	30	
2D-18-30	M18X1.5	M30X2	10	20	35.5	52	27	22	36	
2D-18-36	M18X1.5	M36X2	10	25	38	54	36	22	46	
2D-18-42	M18X1.5	M42X2	10	30	43.5	60	41	22	50	
2D-20-24	M20X1.5	M24X1.5	12	16	33.5	50	22	24	30	
2D-20-30	M20X1.5	M30X2	12	20	35.5	52	27	24	36	
2D-20-36	M20X1.5	M36X2	12	25	38	54	36	24	46	
2D-20-42	M20X1.5	M42X2	12	30	43.5	60	41	24	50	
2D-22-24	M22X1.5	M24X1.5	14	16	33	51	24	27	30	
2D-22-30	M22X1.5	M30X2	14	20	37	55	27	27	36	
2D-22-36	M22X1.5	M36X2	14	25	39.5	57	36	27	46	
2D-22-42	M22X1.5	M42X2	14	30	45	63	41	27	50	
2D-24-30	M24X1.5	M30X2	16	20	37.5	55	30	30	36	
2D-24-36	M24X1.5	M36X2	16	25	39	57	36	30	46	
2D-24-42	M24X1.5	M42X2	16	30	44.5	63	41	30	50	
2D-30-36	M30X2	M36X2	20	25	39	61	36	36	46	
2D-30-42	M30X2	M42X2	20	30	44.5	66	41	36	50	
2D-36-42	M36X2	M42X2	25	30	44	69	41	46	50	
2D-14-52	M14X1.5	M52X2	6	38	47.5	62	50	17	60	
2D-16-52	M16X1.5	M52X2	8	38	47.5	62	50	19	60	
2D-18-52	M18X1.5	M52X2	10	38	47	63	50	22	60	
2D-20-52	M20X1.5	M52X2	12	38	47	63	50	24	60	
2D-22-52	M22X1.5	M52X2	14	38	48.5	66	50	27	60	
2D-24-52	M24X1.5	M52X2	16	38	48	66	50	30	60	
2D-30-52	M30X2	M52X2	20	38	48	70	50	36	60	
2D-36-52	M36X2	M52X2	25	38	48.5	73	50	46	60	
2D-42-52	M42X2	M52X2	30	38	49	76	50	50	60	

注: 如需带卡套及卡套螺母整套订货, 则请在代号后加“RN”, 如2D-30-52RN。

Note: In case if you are interested to order the adapter in complete set with cutting ring and nut , it is necessary to insert suffix "RN" after our part no., for example 2D-30-52RN.

可按用户要求生产各种标准, 型号, 材质的产品

公制螺纹卡套接头

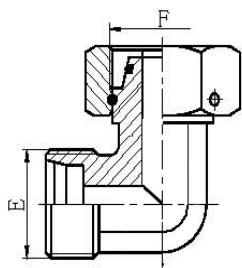

2C9
2D9

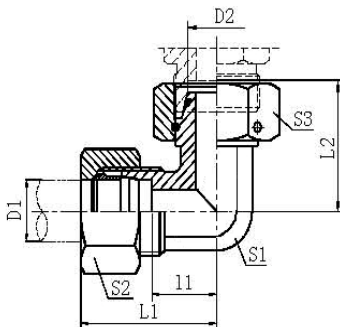

2C9-RN
2D9-RN

90°弯外螺纹内螺纹转换接头

90° ELBOW REDUCER TUBE
ADAPTOR WITH SWIVEL NUT

代号 PART NO.	螺纹 THREAD		管子外径 TUBE O.D.		尺寸 DIMENSIONS						压力等级 Mpa
	E	F	D1	D2	l1	L1	L2	S1	S2	S3	
2C9-12	M12X1.5	M12X1.5	6	6	12	27	26	12	14	14	25 轻系列 L
2C9-14	M14X1.5	M14X1.5	8	8	14	29	27.5	12	17	17	
2C9-16	M16X1.5	M16X1.5	10	10	15	30	29	14	19	19	
2C9-18	M18X1.5	M18X1.5	12	12	17	32	29.5	17	22	22	
2C9-22	M22X1.5	M22X1.5	15	15	21	36	32.5	19	27	27	
2C9-26	M26X1.5	M26X1.5	18	18	23.5	40	35.5	24	32	32	
2C9-30	M30X2	M30X2	22	22	27.5	44	38.5	27	36	36	16 轻系列 L
2C9-36	M36X2	M36X2	28	28	30.5	47	41.5	36	41	41	
2C9-45	M45X2	M45X2	35	35	34.5	56	51	41	50	50	
2C9-52	M52X2	M52X2	42	42	40	63	56	50	60	60	
2D9-14	M14X1.5	M14X1.5	6	6	16	31	27	12	17	17	63 重系列 S
2D9-16	M16X1.5	M16X1.5	8	8	17	32	27.5	14	19	19	
2D9-18	M18X1.5	M18X1.5	10	10	17.5	34	30	17	22	22	
2D9-20	M20X1.5	M20X1.5	12	12	21.5	38	31	17	24	24	
2D9-22	M22X1.5	M22X1.5	14	14	22	40	35	19	27	27	
2D9-24	M24X1.5	M24X1.5	16	16	24.5	43	36.5	24	30	30	
2D9-30	M30X2	M30X2	20	20	26.5	48	44.5	27	36	36	40 重系列 S
2D9-36	M36X2	M36X2	25	25	30	54	50	36	46	46	
2D9-42	M42X2	M42X2	30	30	35.5	62	55	41	50	50	
2D9-52	M52X2	M52X2	38	38	41	72	63	50	60	60	

注: 如需带卡套及卡套螺母整套订货, 则请在代号后加“RN”, 如2C9-30RN。

Note: In case if you are interested to order the adapter in complete set with cutting ring and nut , it is necessary to insert suffix "RN" after our part no., for example 2C9-30RN.

可按用户要求生产各种标准, 型号, 材质的产品

公制螺纹卡套接头

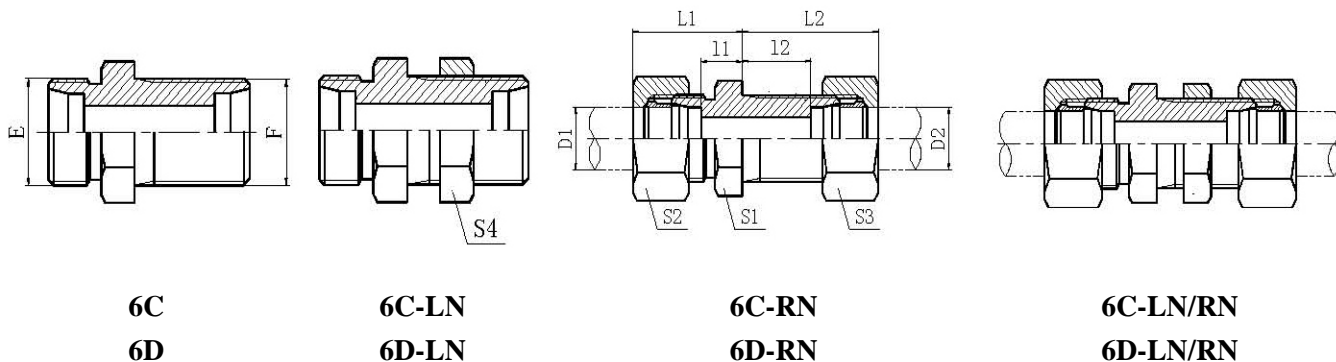

直通过板接头

STRAIGHT BULKHEAD FITTINGS

代号 PART NO.	螺纹 THREAD		管子外径 TUBE O.D.		尺寸 DIMENSIONS							压力等级 Mpa
	E	F	D1	D2	l1	l2	L1	L2	S1	S2,S3	S4	
6C-12	M12X1.5	M12X1.5	6	6	7	27	22	42	17	14	17	31.5 轻系列 L
6C-14	M14X1.5	M14X1.5	8	8	8	27	23	42	19	17	19	
6C-16	M16X1.5	M16X1.5	10	10	10	28	25	43	22	19	22	
6C-18	M18X1.5	M18X1.5	12	12	10	29	25	44	24	22	24	
6C-22	M22X1.5	M22X1.5	15	15	12	31	27	46	27	27	30	
6C-26	M26X1.5	M26X1.5	18	18	13.5	32.5	30	49	32	32	36	
6C-30	M30X2	M30X2	22	22	16.5	34.5	33	51	36	36	41	16 轻系列 L
6C-36	M36X2	M36X2	28	28	18.5	35.5	35	52	41	41	46	
6C-45	M45X2	M45X2	35	35	18.5	36.5	40	58	50	50	55	
6C-52	M52X2	M52X2	42	42	19	36	42	59	60	60	65	
6D-14	M14X1.5	M14X1.5	6	6	12	29	27	44	19	17	19	63 重系列 S
6D-16	M16X1.5	M16X1.5	8	8	13	29	28	44	22	19	22	
6D-18	M18X1.5	M18X1.5	10	10	14.5	29.5	31	46	24	22	24	
6D-20	M20X1.5	M20X1.5	12	12	14.5	30.5	31	47	27	24	27	
6D-22	M22X1.5	M22X1.5	14	14	17	32	35	50	30	27	30	40 重系列 S
6D-24	M24X1.5	M24X1.5	16	16	16.5	31.5	35	50	32	30	32	
6D-30	M30X2	M30X2	20	20	17.5	33.5	39	55	41	36	41	
6D-36	M36X2	M36X2	25	25	20	35	44	59	46	46	46	
6D-42	M42X2	M42X2	30	30	21.5	37.5	48	64	50	50	50	
6D-52	M52X2	M52X2	38	38	22	37	53	68	65	60	65	31.5重系列S

注: 如需带锁母订货, 则请在代号后加“LN”, 如6C-30LN; 如需带卡套及卡套螺母订货, 在代号后加“RN”, 如6C-30RN; 如需带锁母、卡套及卡套螺母订货, 在代号后加“LN/RN”, 如6C-30LN/RN。

Note: In case if you are interested to order the adapter with lock nut, please insert suffix "LN" after our part no. for example 6C-30LN, order the adapter with cutting ring and nut, insert suffix "RN" after part no., for example 6C-30RN, order the adapter with lock nut and cutting ring and nut, insert suffix "LN/RN" after part no., for example 6C-30LN/RN.

可按用户要求生产各种标准, 型号, 材质的产品

公制螺纹卡套接头

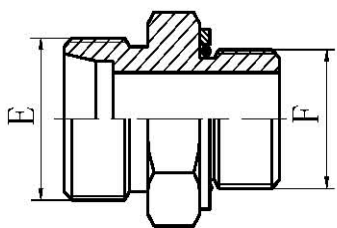

1CH

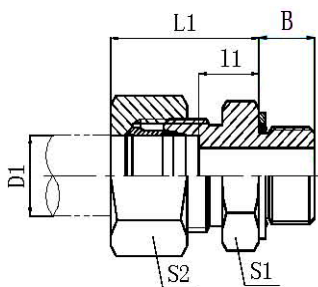

1CH-RN

公制螺纹O形圈密封柱端 ISO 6149
METRIC THREAD STUD ENDS WITH O-RING SEALING ISO 6149

代号 PART NO.	螺 纹 THREAD		管子外径 TUBE O.D.	尺 寸 DIMENSIONS					压力等级 Mpa
	E	F		D1	B	I1	L1	S1	
1CH-12-10	M12X1.5	M10X1	6	8.5	9.5	23	14	14	31.5 轻系列 L
1CH-14	M14X1.5	M14X1.5	8	11	10	25	19	17	
1CH-14-12	M14X1.5	M12X1.5	8	11	10	25	17	17	
1CH-16-14	M16X1.5	M14X1.5	10	11	11	26	19	19	
1CH-18-14	M18X1.5	M14X1.5	12	11	11	25.5	19	22	
1CH-14-18	M14X1.5	M18X1.5	8	12.5	11.5	26.5	24	17	
1CH-16	M16X1.5	M16X1.5	10	11.5	13	28	22	19	
1CH-16-18	M16X1.5	M18X1.5	10	12.5	12.5	28	24	19	
1CH-18-16	M18X1.5	M16X1.5	12	11.5	12	27	22	22	
1CH-22-16	M22X1.5	M16X1.5	12	11.5	13.5	29.5	24	27	
1CH-22-18	M22X1.5	M18X1.5	15	12.5	13.5	29	24	27	
1CH-16-22	M16X1.5	M22X1.5	10	13	14	29.5	27	19	
1CH-22-20	M22X1.5	M20X1.5	15	12	15	30.5	27	27	
1CH-22	M22X1.5	M22X1.5	12	13	15	31	27	27	
1CH-26-22	M26X1.5	M22X1.5	18	13	14.5	31	27	32	
1CH-26	M26X1.5	M26X1.5	18	13.5	13.5	31	32	32	
1CH-26-27	M26X1.5	M27X2	18	16	14.5	32	32	32	
1CH-26-33	M26X1.5	M33X2	18	16	15.5	33	41	32	
1CH-30-22	M30X2	M22X1.5	22	13	17.5	33	32	41	16 轻系列 L
1CH-30-27	M30X2	M27X2	22	16	16.5	33	32	36	
1CH-30	M30X2	M30X2	22	16	17.5	33	36	36	
1CH-36-27	M36X2	M27X2	28	16	17.5	34	41	41	
1CH-36-33	M36X2	M33X2	28	16	17.5	34	41	41	
1CH-36-42	M36X2	M42X2	28	16	18.5	35	50	41	
1CH-45-33	M45X2	M33X2	35	16	17.5	37	46	50	
1CH-45-42	M45X2	M42X2	35	16	17.5	37	50	50	
1CH-52-48	M52X2	M48X2	42	17.5	19		55	60	

注: 如需带卡套及卡套螺母整套订货, 则请在代号后加“RN”, 如1DH-20-18RN。

Note: In case if you are interested to order the adapter in complete set with cutting ring and nut , it is necessary to insert suffix "RN" after our part no., for example 1DH-20-18RN.

可按用户要求生产各种标准, 型号, 材质的产品

公制螺纹卡套接头

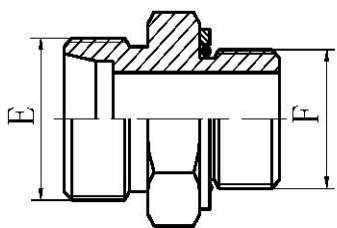

1DH

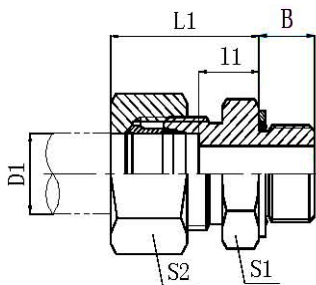

1DH-RN

公制螺纹O形圈密封柱端 ISO 6149

METRIC THREAD STUD ENDS WITH O-RING SEALING ISO 6149

代号 PART NO.	螺 纹 THREAD		管子外径 TUBE O.D.	尺 寸 DIMENSIONS					压力等级 Mpa
	E	F		D1	B	I1	L1	S1	
1DH-14	M14X1.5	M14X1.5	6	11	15	28	19	17	63 重系列 S
1DH-14-12	M14X1.5	M12X1.5	6	11	13	28	17	17	
1DH-16-14	M16X1.5	M14X1.5	8	11	15	30	19	19	
1DH-18-16	M18X1.5	M16X1.5	10	12.5	15	31	22	22	
1DH-20-14	M20X1.5	M14X1.5	12	11	15	31	22	24	
1DH-20-16	M20X1.5	M16X1.5	12	12.5	15	31	22	24	
1DH-20-18	M20X1.5	M18X1.5	12	14	17	33	24	24	
1DH-20-22	M20X1.5	M22X1.5	12	15	17.5	35	27	30	
1DH-24-22	M24X1.5	M22X1.5	16	15	18.5	37	27	30	40 重系列 S
1DH-30	M30X2	M30X2	20	18.5	20.5	42	36	36	
1DH-30-27	M30X2	M27X2	20	18.5	20.5	42	32	36	
1DH-30-33	M30X2	M33X2	20	18.5	22.5	42	41	36	
1DH-36-27	M36X2	M27X2	25	18.5	23	47	41	46	
1DH-36-33	M36X2	M33X2	25	18.5	23	47	41	46	
1DH-42	M42X2	M42X2	30	19	23.5	50	50	50	
1DH-42-48	M42X2	M48X2	30	21.5	26.5	52	55	50	

注: 如需带卡套及卡套螺母整套订货, 则请在代号后加“RN”, 如1DH-20-18RN。

Note: In case if you are interested to order the adapter in complete set with cutting ring and nut , it is necessary to insert suffix "RN" after our part no., for example 1DH-20-18RN.

可按用户要求生产各种标准, 型号, 材质的产品

公制螺纹卡套接头

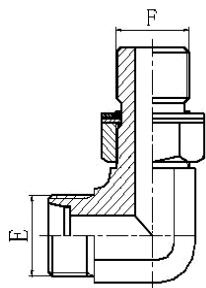

1CH9-OG
1DH9-OG

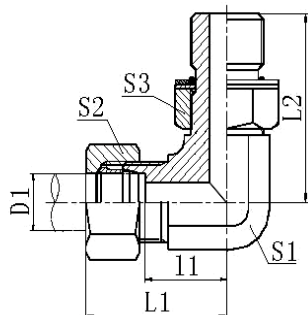

1CH9-OG/RN
1DH9-OG/RN

90°弯公制外螺纹可调向柱端
ISO 6149

90°ELBOW METRIC THREAD
ADJUSTABLE STUD ENDS ISO 6149

代号 PART NO.	螺 纹 THREAD		管子外径 TUBE O.D. D1	O 形圈 O RING	尺 寸 DIMENSIONS						压力等级 Mpa
	E	F			I1	L1	L2	S1	S2	S3	
1CH9-12-10OG	M12X1.5	M10X1	6	8.1X1.6	13	28	26.5	11	14	14	31.5 轻系列 L
1CH9-14-12OG	M14X1.5	M12X1.5	8	9.3X2.4	15.5	30.5	32	14	17	17	
1CH9-16-14OG	M16X1.5	M14X1.5	10	11.3X2.4	17.5	32.5	34	16	19	19	
1CH9-18-16OG	M18X1.5	M16X1.5	12	13.3X2.4	19	34	36	19	22	22	
1CH9-22-18OG	M22X1.5	M18X1.5	15	15.3X2.4	22	37	39.5	22	27	24	
1CH9-26-22OG	M26X1.5	M22X1.5	18	19.3X2.4	25.5	42	43.5	27	32	27	
1CH9-30-27OG	M30X2	M27X2	22	23.5X3.0	29.3	45.8	50	30	36	32	16 轻系列L
1CH9-36-33OG	M36X2	M33X2	28	29.5X3.0	33.3	49.8	54	36	41	41	
1DH9-14-12OG	M14X1.5	M12X1.5	6	9.3X2.4	17.5	32.5	32	14	17	17	63 重系列 S
1DH9-16-14OG	M16X1.5	M14X1.5	8	11.3X2.4	18.7	33.7	34	16	19	19	
1DH9-18-16OG	M18X1.5	M16X1.5	10	13.3X2.4	19.5	36	36	19	22	22	
1DH9-20-18OG	M20X1.5	M18X1.5	12	15.3X2.4	19.5	36	37	19	24	24	
1DH9-22-20OG	M22X1.5	M20X1.5	14	17.3X2.4	23	41	40	22	27	27	
1DH9-24-22OG	M24X1.5	M22X1.5	16	19.3X2.4	24	42	37.5	24	30	27	
1DH9-30-27OG	M30X2	M27X2	20	23.5X3.0	28.3	49.8	50	30	36	32	40 重系列 S
1DH9-36-33OG	M36X2	M33X2	25	29.5X3.0	32.8	56.8	54	36	46	41	
1CH9-42OG	M42X2	M42X2	30	38.5X3.0	36.2	62.7	57.2	41	50	50	S

注: 如需带衬套及螺母整套订货, 则请在代号后加“RN”, 如1CH9-22-18OG/RN。

Note: In case if you are interested to order the adapter in complete set with sleeve and nut , it is necessary to insert suffix "RN" after our part no.,for example 1CH9-22-18OG/RN。

可按用户要求生产各种标准, 型号, 材质的产品

公制螺纹卡套接头

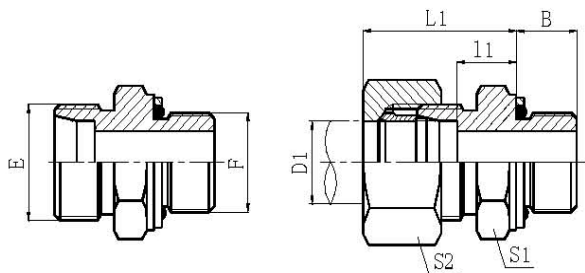

1CG

1CG-RN

英管螺纹O形圈密封柱端

BSP THREAD STUD ENDS WITH O-RING SEALING

代号 PART NO.	螺 纹 THREAD		管子外径 TUBE O.D.	尺 寸 DIMENSIONS					压力等级 Mpa
	E	F		D1	B	l1	L1	S1	
1CG-12-02	M12X1.5	G1/8"X28	6	9.5	8.5	23	14	14	31.5 轻系列 L
1CG-12-04	M12X1.5	G1/4"X19	6	10	10	25	19	14	
1CG-14-04	M14x1.5	G1/4"X19	8	10	10	25	19	17	
1CG-14-06	M14X1.5	G3/8"X19	8	11.5	11.5	26	22	17	
1CG-14-08	M14X1.5	G1/2"X14	8	14	13	27.5	27	17	
1CG-16-04	M16X1.5	G1/4"X19	10	10	11	26	19	19	
1CG-16-06	M16X1.5	G3/8"X19	10	11.5	12.5	27	22	19	
1CG-16-08	M16X1.5	G1/2"X14	10	14	14	29	27	19	
1CG-18-06	M18X1.5	G3/8"X19	12	11.5	12.5	27	22	22	
1CG-18-08	M18X1.5	G1/2"X14	12	14	13	28	27	22	
1CG-22-06	M22X1.5	G3/8"X19	15	11.5	13.5	29	24	27	
1CG-22-08	M22X1.5	G1/2"X14	15	14	14	29	27	27	
1CG-22-12	M22X1.5	G3/4"X14	15	16	15	30	32	32	
1CG-26-08	M26X1.5	G1/2"X14	18	14	14.5	31	27	32	
1CG-26-12	M26X1.5	G3/4"X14	18	16	14.5	32	32	32	
1CG-30-12	M30X2	G3/4"X14	22	16	16.5	33	32	36	16 轻系列 L
1CG-30-16	M30X2	G1"X11	22	18	17.5	35	41	36	
1CG-36-16	M36X2	G1"X11	28	18	17.5	34	41	41	
1CG-45-20	M45X2	G1.1/4"X11	35	20	17.5	39	50	50	
1CG-52-20	M52X2	G1.1/4"X11	42	20	19	42	55	60	
1CG-52-24	M52X2	G1.1/2"X11	42	21.5	19	42	55	60	
1CG-52-32	M52X2	G2"X11	42	24.5	25	44	70	60	

注: 如需带卡套及卡套螺母整套订货, 则请在代号后加“RN”, 如1DG-20-08RN。

Note: In case if you are interested to order the adapter in complete set with cutting ring and nut , it is necessary to insert suffix "RN" after our part no., for example 1DG-20-08RN.

可按用户要求生产各种标准, 型号, 材质的产品

公制螺纹卡套接头

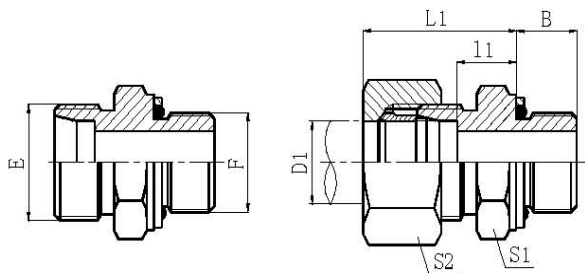

1DG

1DG-RN

英管螺纹O形圈密封柱端

BSP THREAD STUD ENDS WITH O-RING SEALING

代号 PART NO.	螺 纹 THREAD		管子外径 TUBE O.D.	尺 寸 DIMENSIONS					压力等级 Mpa
	E	F		D1	B	l1	L1	S1	
1DG-14-04	M14X1.5	G1/4"X19	6	10	13	28	19	17	63 重系列 S
1DG-16-04	M16X1.5	G1/4"X19	8	10	15	31	19	19	
1DG-18-04	M18X1.5	G1/4"X19	10	10	14.5	31	19	22	
1DG-18-06	M18X1.5	G3/8"X19	10	12	15	31	22	22	
1DG-20-06	M20X1.5	G3/8"X19	12	12	17	32	22	24	
1DG-20-08	M20X1.5	G1/2"X14	12	14	17.5	34	27	24	
1DG-22-06	M22X1.5	G3/8"X19	14	12	19	37	24	27	
1DG-22-08	M22X1.5	G1/2"X14	14	14	19	37	27	27	
1DG-24-04	M24X1.5	G1/4"X19	16	11	18	37	27	30	
1DG-24-08	M24X1.5	G1/2"X14	16	14	18.5	37	27	30	
1DG-30-12	M30X2	G3/4"X14	20	16	20.5	42	32	36	40 重系列 S
1DG-36-12	M36X2	G3/4"X14	25	16	23	47	41	46	
1DG-36-16	M36X2	G1"X11	25	18	23	47	41	46	
1DG-42-16	M42X2	G1"X11	30	18	23.5	48	46	50	
1DG-42-20	M42X2	G1.1/4"X11	30	20	23.5	50	50	50	
1DG-52-24	M52X2	G1.1/2"X11	38	22	26	57	55	60	31.5重系列S

注: 如需带卡套及卡套螺母整套订货, 则请在代号后加“RN”, 如1DG-20-08RN。

Note: In case if you are interested to order the adapter in complete set with cutting ring and nut , it is necessary to insert suffix "RN" after our part no., for example 1DG-20-08RN.

可按用户要求生产各种标准, 型号, 材质的产品

公制螺纹卡套接头

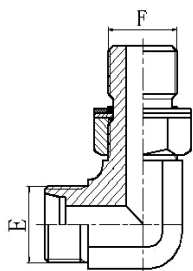

1CG9-OG
1DG9-OG

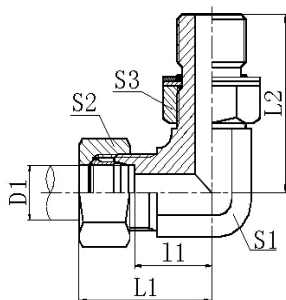

1CG9-OG/RN
1DG9-OG/RN

90°弯英管螺纹可调向O形圈
密封柱端

90° ELBOW BSP THREAD
ADJUSTABLE STUD ENDS WITH
O-RING SEALING

代号 PART NO.	螺纹 THREAD		管子外径 TUBE O.D.	尺寸 DIMENSIONS						压力等级 Mpa
	E	F		D1	l1	L1	L2	S1	S2	
1CG9-12-02OG	M12X1.5	G1/8"X28	6	13	28	26.2	11	14	14	31.5 轻系列 L
1CG9-14-04OG	M14X1.5	G1/4"X19	8	15.5	30.5	31.3	14	17	19	
1CG9-16-04OG	M16X1.5	G1/4"X19	10	17.5	32.5	32.5	16	19	19	
1CG9-16-06OG	M16X1.5	G3/8"X19	10	17.5	32.5	35.8	16	19	22	
1CG9-18-06OG	M18X1.5	G3/8"X19	12	19	34	36.8	19	22	22	
1CG9-22-08OG	M22X1.5	G1/2"X14	15	22	37	43.2	22	27	27	
1CG9-26-08OG	M26X1.5	G1/2"X14	18	25.5	42	46	27	32	27	
1CG9-26-12OG	M26X1.5	G3/4"X14	18	25.5	42	49.3	27	32	32	
1CG9-30-12OG	M30X2	G3/4"X14	22	29.3	45.8	52	30	36	32	
1CG9-30-16OG	M30X2	G1"X11	22	31.5	48	53	33	36	41	
1CG9-36-16OG	M36X2	G1"X11	28	33	49.8	56	36	41	41	
1CG9-36-20OG	M36X2	G1.1/4"X11	28	36	52.8	59	41	41	50	
1CG9-45-20OG	M45X2	G1.1/4"X11	35	39.2	60.7	63	48	50	50	
1CG9-52-24OG	M52X2	G1.1/2"X11	42	44.8	67.8	68.5	55	60	55	63 重系列 S
1DG9-14-04OG	M14X1.5	G1/4"X19	6	17.5	32.5	31.3	14	17	19	
1DG9-16-04OG	M16X1.5	G1/4"X19	8	18.7	33.7	32.5	16	19	19	
1DG9-16-06OG	M16X1.5	G3/8"X19	8	18.7	33.7	35.8	16	19	22	
1DG9-18-06OG	M18X1.5	G3/8"X19	10	19.5	36	36.8	19	22	22	
1DG9-20-06OG	M20X1.5	G3/8"X19	12	19.5	36	36.8	19	24	22	
1DG9-22-08OG	M22X1.5	G1/2"X14	14	23	41	43.2	22	27	27	
1DG9-24-08OG	M24X1.5	G1/2"X14	16	24	42.5	43	24	30	27	40 重系列 S
1DG9-30-12OG	M30X2	G3/4"X14	20	28	49.5	52	30	36	32	
1DG9-36-16OG	M36X2	G1"X11	25	32.8	56.8	56	36	46	41	
1DG9-42-20OG	M42X2	G1.1/4"X11	30	36.2	62.7	58	41	50	50	
1DG9-52-24OG	M52X2	G1.1/2"X11	38	45.8	76.8	68.5	55	60	55	31.5重系列S

注: 如需带卡套及卡套螺母整套订货, 则请在代号后加“RN”, 如1CG9-30-12OG/RN。

Note: In case if you are interested to order the adapter in complete set with cutting ring and nut , it is necessary to insert suffix "RN" after our part no., for example 1CG9-30-12OG/RN.

可按用户要求生产各种标准, 型号, 材质的产品

公制螺纹卡套接头

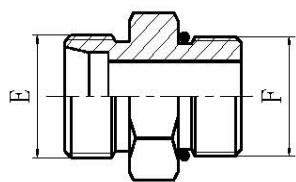

1CO
1DO

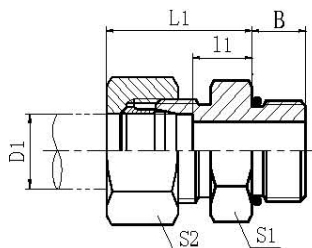

1CO-RN
1DO-RN

美制螺纹O形圈密封柱端
ISO 11926

UN、UNF THREAD STUD ENDS WITH
O-RING SEALING ISO11926

代号 PART NO.	螺 纹 THREAD		管子外径 TUBE O.D	尺 寸 DIMENSIONS						压力等级 Mpa
	E	F		D1	B	l1	L1	S1	S2	
1CO-14-04	M14X1.5	7/16"X20	8	9	10	25	17	17		31.5 轻系列 L
1CO-16-04	M16X1.5	7/16"X20	10	9	11	26	17	19		
1CO-18-06	M18X1.5	9/16"X18	12	10	11	26	19	22		
1CO-18-08	M18X1.5	3/4"X16	12	11	13	28	24	22		
1CO-18-10	M18X1.5	7/8"X14	12	12.7	14.3	29	27	22		
1CO-22-08	M22X1.5	3/4"X16	15	11	14	29	24	27		
1CO-22-10	M22X1.5	7/8"X14	15	12.7	15.3	30	27	27		
1CO-22-12	M22X1.5	1.1/16"X12	15	15	16	30	32	27		
1CO-26-08	M26X1.5	3/4"X16	18	11	14.5	31	27	32		
1CO-26-10	M26X1.5	7/8"X14	18	12.7	14.8	31	27	32		
1CO-30-08	M30X2	3/4"X16	18	11	16.5	33	32	36		
1CO-30-10	M30X2	7/8"X14	22	12.7	16.8	33	32	36		
1CO-30-12	M30X2	1.1/16"X12	22	15	16.5	33	32	36		
1CO-30-16	M30X2	1.5/16"X12	22	15	17.5	34	41	36		
1CO-36-12	M36X2	1.1/16"X12	28	15	17.5	34	41	41		
1CO-36-16	M36X2	1.5/16"X12	28	15	17.5	34	41	41		
1CO-45-16	M45X2	1.5/16"X12	35	15	17.5	39	46	50		
1CO-45-20	M45X2	1.5/8"X12	35	15	17.5	39	50	50		
1CO-52-20	M52X2	1.5/8"X12	42	15	19	42	55	60		
1DO-16-04	M16X1.5	7/16"X20	8	9	15	30	17	19		
1DO-18-06	M18X1.5	9/16"X18	10	10	14.5	31	19	22		
1DO-20-06	M20X1.5	9/16"X18	12	10	14.5	31	22	24		
1DO-20-08	M20X1.5	3/4"X16	12	11	17.5	34	24	24		
1DO-24-08	M24X1.5	3/4"X16	16	11	15.5	34	24	30		
1DO-24-10	M24X1.5	7/8"X14	16	12.7	18.8	37	27	30		
1DO-30-08	M30X2	3/4"X16	20	11	20.5	42	32	36		
1DO-30-10	M30X2	7/8"X14	20	12.7	20.8	42	32	36		
1DO-30-12	M30X2	1.1/16"X12	20	15	20.5	42	32	36		
1DO-36-12	M36X2	1.1/16"X12	25	15	20	47	41	46		
1DO-36-16	M36X2	1.5/16"X12	25	15	23	47	41	46		
1DO-42-16	M42X2	1.5/16"X12	30	15	23.5	50	46	50		
1DO-42-20	M42X2	1.5/8"X12	30	15	23.5	50	50	50		
1DO-52-20	M52X2	1.5/8"X12	38	15	23	54	55	60		

注: 如需带卡套及卡套螺母整套订货, 则请在代号后加“RN”, 如1DO-30-12RN。

Note: In case if you are interested to order the adapter in complete set with cutting ring and nut , it is necessary to insert suffix "RN" after our part no., for example 1DO-30-12RN.

可按用户要求生产各种标准, 型号, 材质的产品

公制螺纹卡套接头

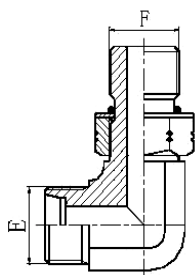

1CO9-OG
1DO9-OG

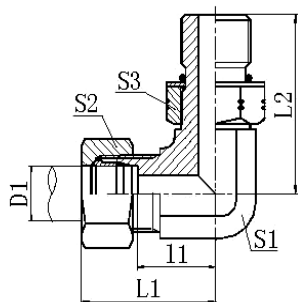

1CO9-OG/RN
1DO9-OG/RN

90°弯美制螺纹可调向O形圈密封
柱端 ISO 11926

90° ELBOW UN、UNF THREAD
ADJUSTABLE STUD ENDS WITH
O-RING SEALING ISO11926

代号 PART NO.	螺纹 THREAD		管子外径 TUBE O.D	尺寸 DIMENSIONS						压力等级 Mpa
	E	F		D1	l1	L1	L2	S1	S2	
1CO9-12-04OG	M12X1.5	7/16"X20	6	13	28	27.2	11	14	17	31.5 轻系列 L
1CO9-14-06OG	M14X1.5	9/16"X18	8	15.5	30.5	31.8	14	17	19	
1CO9-16-06OG	M16X1.5	9/16"X18	10	17.5	32.5	33.3	16	19	19	
1CO9-18-08OG	M18X1.5	3/4"X16	12	19	34	37.5	19	22	24	
1CO9-22-10OG	M22X1.5	7/8"X14	15	22	37	44	22	27	27	
1CO9-22-08OG	M22X1.5	3/4"X16	15	22	37	39.5	22	27	24	
1CO9-26-12OG	M26X1.5	1.1/16"X12	18	25.5	42	51	27	32	32	16 轻系列 L
1CO9-30-12OG	M30X2	1.1/16"X12	22	29.3	45.8	53.5	30	36	32	
1CO9-36-12OG	M36X2	1.1/16"X12	28	33.5	47.8	57.5	36	41	41	
1CO9-36-16OG	M36X2	1.5/16"X12	28	33.3	49.8	57.5	36	41	41	
1CO9-45-20OG	M45X2	1.5/8"X12	35	39.2	60.7	63	48	50	50	
1CO9-52-24OG	M52X2	1.7/8"X12	42	44.8	67.8	70.5	55	60	55	
1DO9-14-04OG	M14X1.5	7/16"X20	6	17.5	32.5	30	14	17	17	63 重系列 S
1DO9-16-06OG	M16X1.5	9/16"X18	8	18.7	33.7	33.3	16	19	19	
1DO9-18-06OG	M18X1.5	9/16"X18	10	19.5	36	33.5	19	22	19	
1DO9-18-08OG	M18X1.5	3/4"X16	10	19.5	36	37.5	19	22	24	
1DO9-20-08OG	M20X1.5	3/4"X16	12	19.5	36	37.5	19	24	24	
1DO9-22-10OG	M22X1.5	7/8"X14	14	23	41	44	22	27	27	
1DO9-24-10OG	M24X1.5	7/8"X14	16	24	42.5	46.5	24	30	27	40 重系列 S
1DO9-30-12OG	M30X2	1.1/16"X12	20	28.3	49.8	53.5	30	36	32	
1DO9-36-16OG	M36X2	1.5/16"X12	25	32.8	56.8	57.5	36	46	41	
1DO9-42-20OG	M42X2	1.5/8"X12	30	36.2	62.7	59.5	41	50	50	
1DO9-52-24OG	M52X2	1.7/8"X12	38	45.8	76.8	70.5	55	60	55	

注: 如需带卡套及卡套螺母整套订货, 则请在代号后加“RN”, 如1CO9-30-12OG/RN。

Note: In case if you are interested to order the adapter in complete set with cutting ring and nut , it is necessary to insert suffix "RN" after our part no., for example 1CO9-30-12OG/RN.

可按用户要求生产各种标准, 型号, 材质的产品

公制螺纹卡套接头

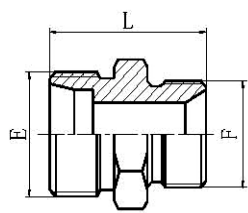

1CB
1DB

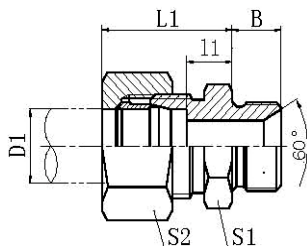

1CB-RN
1DB-RN

英管螺纹60°锥密封或
组合垫密封两用柱端

BSP THREAD 60° CONE SEALING
OR BONDED SEAL STUD ENDS

代号 PART NO.	螺纹 THREAD		管子外径 TUBE O.D	尺寸 DIMENSIONS						压力等级 Mpa
	E	F		D1	B	11	L1	L	S1	
1CB-12-02	M12X1.5	G1/8"X28	6	10	8	23	24	14	14	31.5 轻系列 L
1CB-12-04	M12X1.5	G1/4"X19	6	12	9	24	28	19	14	
1CB-14-02	M14X1.5	G1/8"X28	8	10	8	23	25	14	17	
1CB-14-04	M14X1.5	G1/4"X19	8	12	9	25	28	19	17	
1CB-14-06	M14X1.5	G3/8"X19	8	13.5	9	24	28.5	22	17	
1CB-16-04	M16X1.5	G1/4"X19	10	12	10	25	28	19	19	
1CB-16-06	M16X1.5	G3/8"X19	10	13.5	12.5	25	33	22	19	
1CB-16-08	M16X1.5	G1/2"X14	10	16	11	26	32	27	19	
1CB-18-04	M18X1.5	G1/4"X19	12	12	10	25	29	19	22	
1CB-18-06	M18X1.5	G3/8"X19	12	13.5	10	25	30.5	22	22	
1CB-18-08	M18X1.5	G1/2"X14	12	16	11	26	33	27	22	
1CB-22-06	M22X1.5	G3/8"X19	15	13.5	11	26	31.5	24	27	
1CB-22-08	M22X1.5	G1/2"X14	15	16	12	27	34	27	27	
1CB-26-08	M26X1.5	G1/2"X14	18	16	11.5	28	35	27	32	
1CB-26-12	M26X1.5	G3/4"X14	18	18.5	11.5	28	35.5	32	32	
1CB-30-12	M30X2	G3/4"X14	22	18.5	13.5	30	39.5	32	36	16 轻系列 L
1CB-36-16	M36X2	G1"X11	28	20.5	14.5	31	42.5	41	41	
1CB-45-20	M45X2	G1.1/4"X11	35	20.5	15.5	37	45.5	50	50	
1CB-52-24	M52X2	G1.1/2"X11	42	23	16	39	50	55	60	
1DB-14-04	M14X1.5	G1/4"X19	6	12	13	28	30	19	17	63 重系列 S
1DB-16-04	M16X1.5	G1/4"X19	8	12	13	28	32	19	19	
1DB-16-06	M16X1.5	G3/8"X19	8	13.5	15	32	35.5	22	19	
1DB-18-04	M18X1.5	G1/4"X19	10	12	12.5	29	32	19	22	
1DB-18-06	M18X1.5	G3/8"X19	10	13.5	14.5	31	33.5	22	22	
1DB-18-08	M18X1.5	G1/2"X14	10	16	14.5	31	36	27	22	
1DB-20-04	M20X1.5	G1/4"X19	12	12	14.5	31	34	22	24	
1DB-20-06	M20X1.5	G3/8"X19	12	13.5	14.5	31	35.5	22	24	
1DB-20-08	M20X1.5	G1/2"X14	12	16	14.5	31	38	27	24	
1DB-22-08	M22X1.5	G1/2"X14	14	16	16	34	40	27	27	
1DB-24-06	M24X1.5	G3/8"X19	16	13.5	15.5	34	37.5	27	30	40 重系列 S
1DB-24-08	M24X1.5	G1/2"X14	16	16	15.5	34	40	27	30	
1DB-24-12	M24X1.5	G3/4"X14	16	18.5	17.5	36	44.5	32	30	
1DB-30-12	M30X2	G3/4"X14	20	18.5	17.5	39	48.5	32	36	
1DB-36-08	M36X2	G1/2"X14	25	16	19	43	48	38	46	
1DB-36-12	M36X2	G3/4"X14	25	18.5	19	43	50.5	38	46	
1DB-36-16	M36X2	G1"X11	25	20.5	20	44	52.5	41	46	
1DB-42-20	M42X2	G1.1/4"X11	30	20.5	21.5	48	54.5	50	50	
1DB-52-24	M52X2	G1.1/2"X11	38	23	23	54	62	55	60	

注: 如需带卡套及卡套螺母整套订货, 则请在代号后加“RN”, 如1DB-20-08RN。

Note: In case if you are interested to order the adapter in complete set with cutting ring and nut , it is necessary to insert suffix "RN" after our part no., for example 1DB-20-08RN.

可按用户要求生产各种标准, 型号, 材质的产品

公制螺纹卡套接头

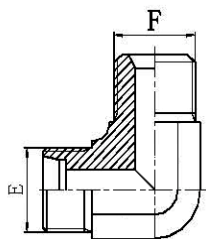

1CB9
1DB9

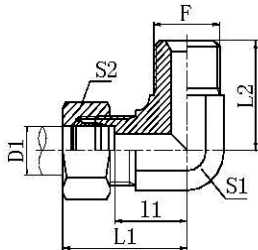

1CB9-RN
1DB9-RN

90°弯英管螺纹60°锥密封

90° ELBOW BSP THREAD
60° CONE SEALING

代号 PART NO.	螺 纹 THREAD		管子外径 TUBE O.D	尺 寸 DIMENSIONS						压力等级 Mpa
	E	F		D1	l1	L1	L2	S1	S2	
1CB9-12-04	M12X1.5	G1/4"X19	6	15.5	30.5	24.5	14	14	31.5 轻系列 L	
1CB9-14-04	M14X1.5	G1/4"X19	8	15.5	30.5	24.5	14	17		
1CB9-14-06	M14X1.5	G3/8"X19	8	16.5	31.5	27.5	16	17		
1CB9-16-04	M16X1.5	G1/4"X19	10	17.5	32.5	26.5	16	19		
1CB9-16-06	M16X1.5	G3/8"X19	10	17.5	32.5	27.5	16	19		
1CB9-16-08	M16X1.5	G1/2"X14	10	21	36	34.5	22	19		
1CB9-18-04	M18X1.5	G1/4"X19	12	19	34	27.5	19	22		
1CB9-18-06	M18X1.5	G3/8"X19	12	19	36	28.5	19	22		
1CB9-18-08	M18X1.5	G1/2"X14	12	21	35.5	34.5	22	22		
1CB9-22-06	M22X1.5	G3/8"X19	15	22	37	31	22	27		
1CB9-22-08	M22X1.5	G1/2"X14	15	22	37	34.5	22	27		
1CB9-26-08	M26X1.5	G1/2"X14	18	25.5	42	37.5	27	32		
1CB9-30-12	M30X2	G3/4"X14	22	29.5	46	41	30	36	16 轻系列 L	
1CB9-36-16	M36X2	G1"X11	28	33.3	49.8	47.5	36	41		
1CB9-45-20	M45X2	G1.1/4"X11	35	39.2	60.7	54.5	48	50		
1CB9-52-24	M52X2	G1.1/2"X11	42	44.8	67.8	63	55	60		
1DB9-14-04	M14X1.5	G1/4"X19	6	17.5	32.5	24.5	14	17	63 重系列 S	
1DB9-16-04	M16X1.5	G1/4"X19	8	18.7	33.7	26.5	16	19		
1DB9-16-06	M16X1.5	G3/8"X19	8	18.7	33.7	27.5	16	19		
1DB9-18-04	M18X1.5	G1/4"X19	10	19.5	36	27.5	19	22		
1DB9-18-06	M18X1.5	G3/8"X19	10	19.5	36	28.5	19	22		
1DB9-18-08	M18X1.5	G1/2"X14	10	21.5	38	34.5	22	22		
1DB9-20-04	M20X1.5	G1/4"X19	12	19.5	36	27.5	19	24		
1DB9-20-06	M20X1.5	G3/8"X19	12	19.5	36	28.5	19	24		
1DB9-20-08	M20X1.5	G1/2"X14	12	21.5	38	34.5	22	24		
1DB9-22-08	M22X1.5	G1/2"X14	14	23	41	34.5	22	27		
1DB9-24-06	M24X1.5	G3/8"X19	16	24	42.5	32	24	30	40 重系列 S	
1DB9-24-08	M24X1.5	G1/2"X14	16	24	42.5	35	24	30		
1DB9-24-12	M24X1.5	G3/4"X14	16	26	44.5	40	27	30		
1DB9-30-12	M30X2	G3/4"X14	20	28.3	49.8	41	30	36		
1DB9-36-08	M36X2	G1/2"X14	25	32.8	56.8	42.5	36	46		
1DB9-36-12	M36X2	G3/4"X14	25	32.8	56.8	43.5	36	46		
1DB9-36-16	M36X2	G1"X11	25	32.8	56.8	47.5	36	46		
1DB9-42-20	M42X2	G1.1/4"X11	30	36.2	62.7	50.5	41	50		
1DB9-52-24	M52X2	G1.1/2"X11	38	45.8	76.8	63	55	60		
1DB9-52-24	M52X2	G1.1/2"X11	38	45.8	76.8	63	55	60		31.5重系列S

注: 如需带卡套及卡套螺母整套订货, 则请在代号后加“RN”, 如1DB9-24-12RN。

Note: In case if you are interested to order the adapter in complete set with cutting ring and nut, it is necessary to insert suffix "RN" after our part no., for example 1DB9-24-12RN.

可按用户要求生产各种标准, 型号, 材质的产品

公制螺纹卡套接头

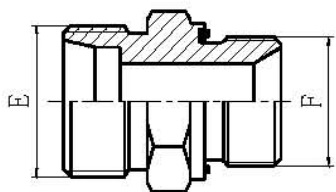

1CB-WD

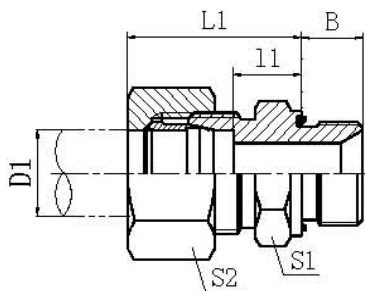

1CB-WD/RN

英管螺纹胶垫密封柱端

BSP THERAD WITH CAPTIVE SEAL

代号 PART NO.	螺纹 THREAD		管子外径 TUBE O.D. D1	胶垫 SEAL	尺寸 DIMENSIONS					压力等级 Mpa
	E	F			B	l1	L1	S1	S2	
1CB-12-02WD	M12X1.5	G1/8"X28	6	WD-B02	8	8.5	23.5	14	14	31.5 轻系列 L
1CB-12-04WD	M12X1.5	G1/4"X19	6	WD-B04	12	10	25	19	14	
1CB-12-06WD	M12X1.5	G3/8"X19	6	WD-B06	12	11.5	26.5	22	14	
1CB-14-02WD	M14X1.5	G1/8"X28	8	WD-B02	8	9	24	14	17	
1CB-14-04WD	M14X1.5	G1/4"X19	8	WD-B04	12	10	24	19	17	
1CB-14-06WD	M14X1.5	G3/8"X19	8	WD-B06	12	11	26	22	17	
1CB-16-04WD	M16X1.5	G1/4"X19	10	WD-B04	12	11	24.5	19	19	
1CB-16-06WD	M16X1.5	G3/8"X19	10	WD-B06	12	12.5	26	22	19	
1CB-16-08WD	M16X1.5	G1/2"X14	10	WD-B08	14	13	28	27	19	
1CB-18-04WD	M18X1.5	G1/4"X19	12	WD-B04	12	12	27	19	22	
1CB-18-06WD	M18X1.5	G3/8"X19	12	WD-B06	12	12.5	26	22	22	
1CB-18-08WD	M18X1.5	G1/2"X14	12	WD-B08	14	14	28	27	22	
1CB-22-04WD	M22X1.5	G1/4"X19	15	WD-B04	12	13	28	24	27	
1CB-22-06WD	M22X1.5	G3/8"X19	15	WD-B06	12	13.5	28	24	27	
1CB-22-08WD	M22X1.5	G1/2"X14	15	WD-B08	14	14	29	27	27	
1CB-22-12WD	M22X1.5	G3/4"X14	15	WD-B12	16	15	29	32	27	
1CB-26-08WD	M26X1.5	G1/2"X14	18	WD-B08	14	14.5	31	27	32	
1CB-26-12WD	M26X1.5	G3/4"X14	18	WD-B12	16	14.5	31	32	32	
1CB-30-12WD	M30X2	G3/4"X14	22	WD-B12	16	16.5	33	32	36	16 轻系列 L
1CB-36-16WD	M36X2	G1"X11	28	WD-B16	18	17.5	34	41	41	
1CB-36-20WD	M36X2	G1.1/4"X11	28	WD-B20	18	17.5	34	50	41	
1CB-45-20WD	M45X2	G1.1/4"X11	35	WD-B20	20	17.5	39	50	50	
1CB-52-24WD	M52X2	G1.1/2"X11	42	WD-B24	22	19	42	55	60	

注: 如需带衬套及螺母整套订货, 则请在代号后加“RN”, 如1CB-22-04WD/RN。

Note: In case if you are interested to order the adapter in complete set with sleeve and nut , it is necessary to insert suffix "RN" after our part no.,for example 1CB-22-04WD/RN.

可按用户要求生产各种标准, 型号, 材质的产品

公制螺纹卡套接头

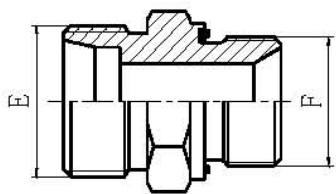

1DB-WD

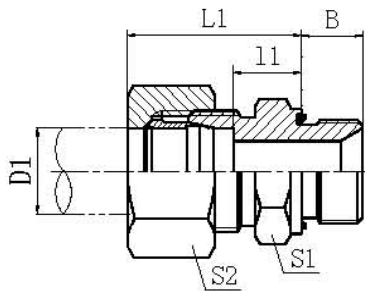

1DB-WD/RN

英管螺纹胶垫密封柱端

BSP THERAD WITH CAPTIVE SEAL

代号 PART NO.	螺纹 THREAD		管子外径 TUBE O.D. D1	胶垫 SEAL	尺寸 DIMENSIONS					压力等级 Mpa
	E	F			B	l1	L1	S1	S2	
1DB-14-04WD	M14X1.5	G1/4"X19	6	WD-B04	12	15		19	17	63 重系列 S
1DB-16-04WD	M16X1.5	G1/4"X19	8	WD-B04	12	15	30	19	19	
1DB-16-06WD	M16X1.5	G3/8"X19	8	WD-B06	12	15.5	30	22	19	
1DB-18-04WD	M18X1.5	G1/4"X19	10	WD-B04	12	14.5	31	19	22	
1DB-18-06WD	M18X1.5	G3/8"X19	10	WD-B06	12	14.5	31	22	22	
1DB-18-08WD	M18X1.5	G1/2"X14	10	WD-B08	14	17.5	34	27	22	
1DB-20-04WD	M20X1.5	G1/4"X19	12	WD-B04	12	16.5	33	22	24	
1DB-20-06WD	M20X1.5	G3/8"X19	12	WD-B06	12	15	33	22	24	
1DB-20-08WD	M20X1.5	G1/2"X14	12	WD-B08	14	17.5	34	27	24	
1DB-22-08WD	M22X1.5	G1/2"X14	14	WD-B08	14	19	37	27	27	
1DB-24-06WD	M24X1.5	G3/8"X19	16	WD-B06	12	18	36.5	27	30	40 重系列 S
1DB-24-08WD	M24X1.5	G1/2"X14	16	WD-B08	14	18.5	37	27	30	
1DB-24-12WD	M24X1.5	G3/4"X14	16	WD-B12	16	20.5	39	32	30	
1DB-30-12WD	M30X2	G3/4"X14	20	WD-B12	16	20.5	42	32	36	
1DB-36-08WD	M36X2	G1/2"X14	25	WD-B08	14	23	47	41	46	
1DB-36-12WD	M36X2	G3/4"X14	25	WD-B12	16	23	47	41	46	
1DB-36-16WD	M36X2	G1"X11	25	WD-B16	18	23	47	41	46	
1DB-42-20WD	M42X2	G1.1/4"X11	30	WD-B20	20	23.5	50	50	50	31.5重系列S
1DB-52-24WD	M52X2	G1.1/2"X11	38	WD-B24	22	26	57	55	60	

注: 如需带衬套及螺母整套订货, 则请在代号后加“RN”, 如1CB-22-04WD/RN。

Note: In case if you are interested to order the adapter in complete set with sleeve and nut , it is necessary to insert suffix "RN" after our part no.,for example 1CB-22-04WD/RN。

可按用户要求生产各种标准, 型号, 材质的产品

公制螺纹卡套接头

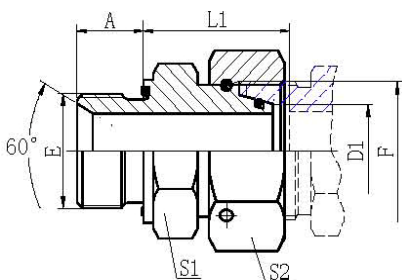

2BC-WD
2BD-WD

英管螺纹胶垫密封柱端/
公制内螺纹24°锥O形圈密封

BSP THREAD WITH CAPTIVE SEAL/
METRIC FEMALE 24° CONE
O-RING SEALING

代号 PART NO.	螺纹 THREAD		管子外径 TUBE O.D. D1	胶垫 SEAL	尺寸 DIMENSIONS					压力等级 Mpa
	E	F			A	L1	S1	S2		
2BC-02-12WD	G1/8"X28	M12X1.5	6	WD-B02	8	24.5	14	14		31.5 轻系列 L
2BC-04-14WD	G1/4"X19	M14X1.5	8	WD-B04	12	29.5	19	17		
2BC-04-16WD	G1/4"X19	M16X1.5	10	WD-B04	12	27.5	19	19		
2BC-06-18WD	G3/8"X19	M18X1.5	12	WD-B06	12	34	22	22		
2BC-08-22WD	G1/2"X14	M22X1.5	15	WD-B08	14	32	27	27		
2BC-08-26WD	G1/2"X14	M26X1.5	18	WD-B08	14	31.5	27	32		
2BC-12-30WD	G3/4"X14	M30X2	22	WD-B12	16	32.5	32	36		16 轻系列 L
2BC-16-36WD	G1"X11	M36X2	28	WD-B16	18	35	41	41		
2BC-20-45WD	G1.1/4"X11	M45X2	35	WD-B20	20	42.5	50	50		
2BC-24-52WD	G1.1/2"X11	M52X2	42	WD-B24	22	46.5	55	60		
2BD-04-14WD	G1/4"X19	M14X1.5	6	WD-B04	12	27	19	17		63 重系列 S
2BD-04-16WD	G1/4"X19	M16X1.5	8	WD-B04	12	29.5	19	19		
2BD-06-18WD	G3/8"X19	M18X1.5	10	WD-B06	12	32	22	22		
2BD-06-20WD	G3/8"X19	M20X1.5	12	WD-B06	12	34	22	24		
2BD-08-22WD	G1/2"X14	M22X1.5	14	WD-B08	14	36.5	27	27		
2BD-08-24WD	G1/2"X14	M24X1.5	16	WD-B08	14	37	27	30		
2BD-12-30WD	G3/4"X14	M30X2	20	WD-B12	16	43	32	36		40 重系列 S
2BD-16-36WD	G1"X11	M36X2	25	WD-B16	18	48	41	46		
2BD-20-42WD	G1.1/4"X11	M42X2	30	WD-B20	20	51	50	50		
2BD-24-52WD	G1.1/2"X11	M52X2	38	WD-B24	22	60	55	60		
										31.5重系列S

可按用户要求生产各种标准, 型号, 材质的产品

公制螺纹卡套接头

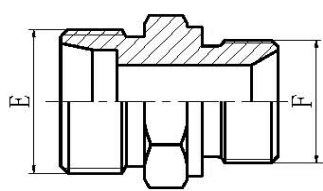

1CM
1DM

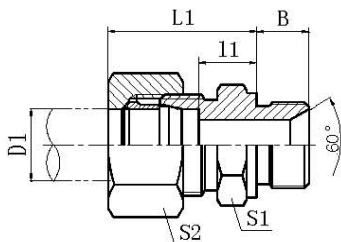

1CM-RN
1DM-RN

公制螺纹60°锥密封或
组合垫密封两用柱端
METRIC THREAD 60° CONE
SEALING OR
BONDED SEAL STUD ENDS

代号 PART NO.	螺 纹 THREAD		管子外径 TUBE O.D.	尺 寸 DIMENSIONS					压力等级 Mpa
	E	F		D1	B	l1	L1	S1	
1CM-12-10	M12X1.5	M10X1	6	8	8.5	23	14	14	31.5 轻系列 L
1CM-14-12	M14X1.5	M12X1.5	8	12	10	25	17	17	
1CM-14-18	M14X1.5	M18X1.5	8	12	11.5	26	24	17	
1CM-16-14	M16X1.5	M14X1.5	10	12	11	26	19	19	
1CM-16	M16X1.5	M16X1.5	10	12	12	27	22	19	
1CM-16-18	M16X1.5	M18X1.5	10	12	12.5	27	24	19	
1CM-16-22	M16X1.5	M22X1.5	10	14	14	29	27	19	
1CM-18-14	M18X1.5	M14X1.5	12	12	11	26	19	22	
1CM-18-16	M18X1.5	M16X1.5	12	12	12	27	22	22	
1CM-18	M18X1.5	M18X1.5	12	12	12.5	27	24	22	
1CM-18-22	M18X1.5	M22X1.5	12	14	14	29	27	22	
1CM-22-16	M22X1.5	M16X1.5	15	12	13	28	24	27	
1CM-22-18	M22X1.5	M18X1.5	15	12	13.5	29	24	27	
1CM-22	M22X1.5	M22X1.5	15	14	15	30	27	27	
1CM-26-18	M26X1.5	M18X1.5	18	12	14	30	27	32	
1CM-26-22	M26X1.5	M22X1.5	18	14	14.5	31	27	32	
1CM-30-22	M30X2	M22X1.5	22	14	16.5	33	32	36	16 轻系列 L
1CM-30-26	M30X2	M26X1.5	22	16	16.5	33	32	36	
1CM-30-27	M30X2	M27X1.5	22	16	18.5	35	32	36	
1CM-36-33	M36X2	M33X2	28	18	17.5	34	41	41	
1CM-45-42	M45X2	M42X2	35	20	17.5	39	50	50	
1CM-52-48	M52X2	M48X2	42	22	19	42	55	60	63 重系列 S
1DM-14-12	M14X1.5	M12X1.5	6	12	13	28	17	17	
1DM-16-14	M16X1.5	M14X1.5	8	12	15	30	19	19	
1DM-18-16	M18X1.5	M16X1.5	10	12	15	31	22	22	
1DM-20-18	M20X1.5	M18X1.5	12	12	17	33	24	24	
1DM-20-22	M20X1.5	M22X1.5	12	14	17.5	34	27	24	
1DM-22-20	M22X1.5	M20X1.5	14	14	19	37	27	27	
1DM-24-18	M24X1.5	M18X1.5	16	12	18	36	27	30	40 重系列 S
1DM-24-22	M24X1.5	M22X1.5	16	14	18.5	37	27	30	
1DM-30-27	M30X2	M27X2	20	16	20.5	42	32	36	
1DM-36-33	M36X2	M33X2	25	18	23	47	41	46	
1DM-42	M42X2	M42X2	30	20	23.5	50	50	50	25 重系列S
1DM-52-48	M52X2	M48X2	38	22	57	55	60		

注: 如需带卡套及卡套螺母整套订货, 则请在代号后加“RN”, 如1DM-20-18RN。

Note: In case if you are interested to order the adapter in complete set with cutting ring and nut , it is necessary to insert suffix "RN" after our part no., for example 1DM-20-18RN.

可按用户要求生产各种标准, 型号, 材质的产品

公制螺纹卡套接头

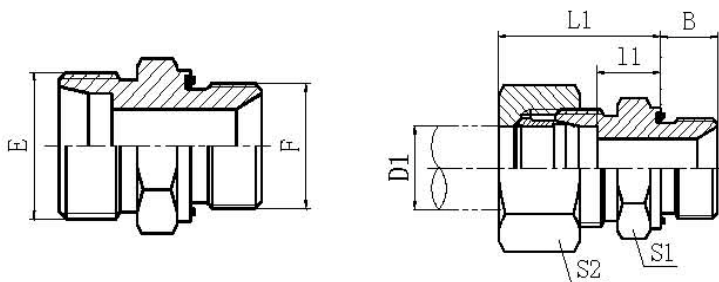

公制螺纹胶垫密封柱端

METRIC THERAD WITH CAPTIVE SEAL

1CM-WD
1DM-WD

1CM-WD/RN
1DM-WD/RN

代号 PART NO.	螺纹 THREAD		管子外径 TUBE O.D. D1	胶垫 SEAL	尺寸 DIMENSIONS					压力等级 Mpa
	E	F			B	11	L1	S1	S2	
1CM-12-10WD	M12X1.5	M10X1.5	6	WD-B02	8	8.5	23	14	14	31.5 轻系列 L
1CM-14-12WD	M14X1.5	M12X1.5	8	WD-M12	12	10	25	17	17	
1CM-16-12WD	M16X1.5	M12X1.5	10	WD-M12	12	11	25	17	19	
1CM-16-14WD	M16X1.5	M14X1.5	10	WD-B04	12	11	26	19	19	
1CM-16-18WD	M16X1.5	M18X1.5	10	WD-M18	12	12.5	27	24	19	
1CM-18-16WD	M18X1.5	M16X1.5	12	WD-M16	12	12.5	27	22	22	
1CM-18WD	M18X1.5	M18X1.5	12	WD-M18	12	12.5	27	24	22	
1CM-18-22WD	M18X1.5	M22X1.5	12	WD-M22	14	14	29	27	22	
1CM-22-18WD	M22X1.5	M18X1.5	15	WD-M18	12	13.5	29	24	27	
1CM-22WD	M22X1.5	M22X1.5	15	WD-M22	14	15	30	27	27	
1CM-26-18WD	M26X1.5	M18X1.5	18	WD-M18	14	14.5	31	27	32	
1CM-26-22WD	M26X1.5	M22X1.5	18	WD-M22	14	14.5	31	27	32	
1CM-30-26WD	M30X2	M26X1.5	22	WD-B12	16	16.5	33	32	36	16 轻系列 L
1CM-30-27WD	M30X2	M27X1.5	22	WD-B12	16	16.5	33	32	36	
1CM-30-33WD	M30X2	M33X2	22	WD-B12	16	17.5	33	41	36	
1CM-36-33WD	M36X2	M33X2	28	WD-B16	18	17.5	34	41	41	
1CM-45-42WD	M45X2	M42X2	35	WD-B20	20	17.5	39	50	50	
1CM-52-48WD	M52X2	M48X2	42	WD-B24	22	19	42	55	60	
1DM-14-12WD	M14X1.5	M12X1.5	6	WD-M12	12	13	28	17	17	63 重系列 S
1DM-16-14WD	M16X1.5	M14X1.5	8	WD-B04	12	15	30	19	19	
1DM-18-16WD	M18X1.5	M16X1.5	10	WD-M16	12	15	31	22	22	
1DM-20-18WD	M20X1.5	M18X1.5	12	WD-M18	12	17	33	24	24	
1DM-22-20WD	M22X1.5	M20X1.5	14	WD-M20	14	19	37	27	27	
1DM-24-22WD	M24X1.5	M22X1.5	16	WD-M22	14	18.5	37	27	30	40 重系列S
1DM-30-27WD	M30X2	M27X2	20	WD-B12	16	20.5	42	32	36	
1DM-36-33WD	M36X2	M33X2	25	WD-B16	18	23	47	41	46	
1DM-42WD	M42X2	M42X2	30	WD-B20	20	23.5	50	50	50	
1DM-52-48WD	M52X2	M48X2	38	WD-B24	22	26	57	55	60	31.5重系列S

注: 如需带衬套及螺母整套订货, 则请在代号后加“RN”, 如1CM-22-18WD/RN。

Note: In case if you are interested to order the adapter in complete set with sleeve and nut , it is necessary to insert suffix "RN" after our part no.,for example 1CM-22-18WD/RN/RN。

可按用户要求生产各种标准, 型号, 材质的产品

公制螺纹卡套接头

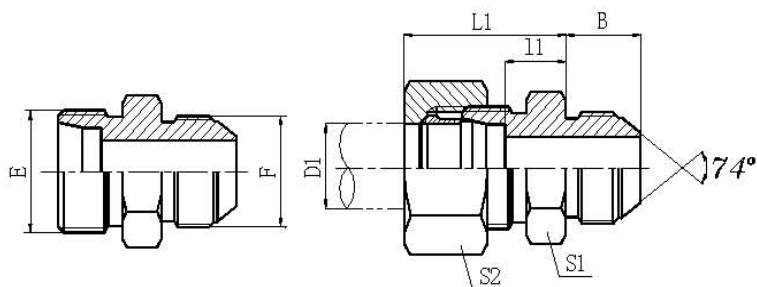

美制JIC74°锥密封

JIC 74° CONE SEALING

1CJ
1DJ

1CJ-RN
1DJ-RN

代号 PART NO.	螺 纹 THREAD		管子外径 TUBE O.D.	尺 寸 DIMENSIONS					压力等级 Mpa
	E	F		D1	B	l1	L1	S1	
1CJ-12-04	M12X1.5	7/16"X20	6	14	9	24	14	14	31.5 轻系列 L
1CJ-14-04	M14X1.5	7/16"X20	8	14	8	23	14	17	
1CJ-14-06	M14X1.5	9/16"X18	8	14.1	8	23	14	17	
1CJ-16-06	M16X1.5	9/16"X18	10	14.1	9	24	17	19	
1CJ-18-06	M18X1.5	9/16"X18	12	14.1	10	25	19	22	
1CJ-18-08	M18X1.5	3/4"X16	12	16.7	10	25	22	22	
1CJ-22-08	M22X1.5	3/4"X16	15	16.7	10.8	26	24	27	
1CJ-22-10	M22X1.5	7/8"X14	15	19.3	11	26	24	27	
1CJ-26-10	M26X1.5	7/8"X14	18	19.3	11.5	28	27	32	
1CJ-26-12	M26X1.5	1.1/16"X12	18	21.9	11.6	28	30	32	
1CJ-30-12	M30X2	1.1/16"X12	22	21.9	13.5	30	32	36	16 轻系列 L
1CJ-36-16	M36X2	1.5/16"X12	28	23.1	14.5	31	38	41	
1CJ-45-20	M45X2	1.5/8"X12	35	24.3	14.5	36	46	50	
1CJ-52-20	M52X2	1.5/8"X12	42	24.3	16	39	55	60	
1CJ-52-24	M52X2	1.7/8"X12	42	27.5	16	39	55	60	
1DJ-14-04	M14X1.5	7/16"X20	6	14	11	26	14	17	63 重系列 S
1DJ-16-04	M16X1.5	7/16"X20	8	14	13	28	17	19	
1DJ-16-06	M16X1.5	9/16"X18	8	14.1	12.9	28	17	34	
1DJ-18-04	M18X1.5	7/16"X20	10	14	12.5	29	19	22	
1DJ-18-06	M18X1.5	9/16"X18	10	14.1	12.5	29	19	22	
1DJ-20-06	M20X1.5	9/16"X18	12	14.1	14.5	31	22	24	
1DJ-20-08	M20X1.5	3/4"X16	12	16.7	14.3	31	22	24	
1DJ-22-08	M22X1.5	3/4"X16	14	16.7	16	34	24	27	
1DJ-24-08	M24X1.5	3/4"X16	16	16.7	15.5	34	27	30	40 重系列 S
1DJ-30-12	M30X2	1.1/16"X12	20	21.9	17.5	39	32	36	
1DJ-36-12	M36X2	1.1/16"X12	25	21.9	19	43	38	46	
1DJ-36-16	M36X2	1.5/16"X12	25	23.1	19	43	38	46	
1DJ-42-20	M42X2	1.5/8"X12	30	24.3	20.5	47	46	50	
1DJ-52-24	M52X2	1.7/8"X12	38	27.5	23	54	55	60	31.5重系列S

注: 如需带卡套及卡套螺母整套订货, 则请在代号后加“RN”, 如1DJ-20-08RN。

Note: In case if you are interested to order the adapter in complete set with cutting ring and nut , it is necessary to insert suffix "RN" after our part no., for example 1DJ-20-08RN.

可按用户要求生产各种标准, 型号, 材质的产品

公制螺纹卡套接头

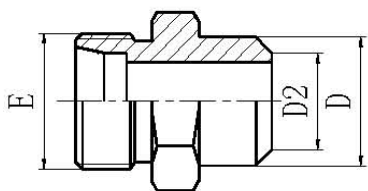

1CW
1DW

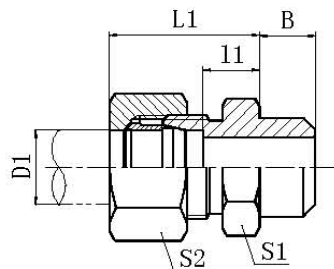

1CW-RN
1DW-RN

焊接接头

WELD FITTINGS

代号 PART NO.	螺纹 THREAD		管子外径 TUBE O.D.		尺寸 DIMENSIONS						压力等级 Mpa
	E		D1	D2	B	D	I1	L1	S1	S2	
1CW-12-06	M12X1.5		6	6	7	10	7	22	12	14	31.5 轻系列 L
1CW-14-08	M14X1.5		8	8	8	12	8	23	14	17	
1CW-16-10	M16X1.5		10	10	8	14	9	24	17	19	
1CW-18-12	M18X1.5		12	12	8	16	10	25	19	22	
1CW-22-15	M22X1.5		15	15	10	19	11	26	22	27	
1CW-26-18	M26X1.5		18	18	10	22	11.5	28	27	32	
1CW-26-22	M26X1.5		18	22	10	27	13.5	28	27	32	16 轻系列 L
1CW-30-22	M30X2		22	22	12	27	13.5	30	32	36	
1CW-30-25	M30X2		22	25	12	31	13.5	30	32	36	
1CW-36-28	M36X2		28	28	12	32	16.5	33	38	41	
1CW-45-35	M45X2		35	35	14	40	14.5	36	46	50	
1CW-52-42	M52X2		42	42	16	46	16	39	55	60	63 重系列 S
1DW-14-06	M14X1.5		6	6	7	11	11	26	14	17	
1DW-16-08	M16X1.5		8	8	8	13	13	28	17	19	
1DW-18-10	M18X1.5		10	10	8	15	12.5	29	19	22	
1DW-20-12	M20X1.5		12	12	10	17	14.5	31	22	24	
1DW-22-14	M22X1.5		14	14	10	19	16	34	24	27	
1DW-24-16	M24X1.5		16	16	10	21	15.5	34	27	30	40 重系列 S
1DW-30-20	M30X2		20	20	12	26	17.5	39	32	36	
1DW-36-25	M36X2		25	25	12	31	20	44	41	46	
1DW-42-30	M42X2		30	30	14	36	20.5	47	46	50	
1DW-52-38	M52X2		38	38	16	44	23	54	55	60	31.5重系列S

注: 如需带卡套及卡套螺母整套订货, 则请在代号后加“RN”, 如1DW-20-12RN。

Note: In case if you are interested to order the adapter in complete set with cutting ring and nut , it is necessary to insert suffix "RN" after our part no., for example 1DW-20-12RN.

可按用户要求生产各种标准, 型号, 材质的产品